

**LEGEND**

- Area of Disturbance
- Water Treatment Pond
- Wetland mapped on Brunswick Site
- Structure - Planned
- Structure - Planned - Removed at Reclamation
- Brunswick Industrial Site - Boundary
- Elevation Contour Line - 10 foot intervals
- Elevation Contour Line - 2 foot intervals
- Temporary excavation for Service Raise construction Contour Line - 10 foot intervals
- Creek - Perennial
- Creek - Intermittent
- Creek - Ephemeral
- NID Canal
- NID Spillway
- Setback - "Non-disturbance buffer" (approximate)
- Buried Culvert (Existing)

Sensitive resources based on reports:

Brunswick Industrial Site and East Bennett Road ROW  
Biological Resources Assessment  
Greg Matuzak Environmental Consulting LLC, November 2019

Brunswick Industrial Site and East Bennett Road ROW  
Aquatic Resources Delineation of Water of the United States and State of California  
Greg Matuzak Environmental Consulting LLC, November 2019



Brunswick Industrial Site  
Nevada County, SEC. 31, T.16N, R.9E., M.D.M  
Total Area = 118.93 Acres  
Assessor Parcel Numbers:  
09-630-37, 09-630-39, 09-441-03, 09-441-04,  
09-441-05, 09-441-34  
Current Zoning M1-SP / Proposed Zoning M1-ME

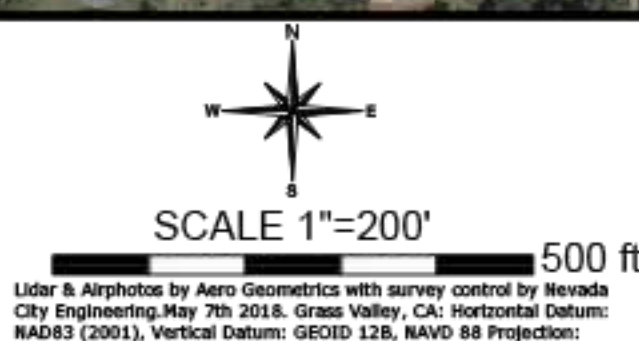

**B102 Brunswick Industrial Site Plan**  
**Biological and Cultural Summary Map**  
Area of disturbance and surrounding area with current air photo  
**Revision 1**  
Drawn by: Rise Grass Valley - Feb 1 / 20 Scale: 1" = 200 feet